

Provides easy access to reels and hydraulic systems.

OVERHEAD CABLE EQUALIZATION
for unobstructed floor surface.

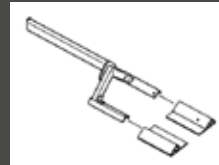

Wheel adapter kit to raise vehicles with less than 330 mm wheels.



THE DUAL CONTROL PANELS - one on each side of the lift - ensure that you have complete control no matter where you're standing, streamlining your workflow and enhancing efficiency.



ADJUSTABLE DRIVE-OVER RAMPS AND SIDE RAILS provide the width to support wider vehicles during approach.

Wheel engaging chocks wheels automatically.

Lift can accommodate both **3-WHEEL** (1100 kg) **AND 4-WHEEL** (2300 kg) **TURF EQUIPMENT.**



**ELECTRO-HYDRAULIC
2-POST LIFTS**

TLO7

TECHNICAL DATA

	TLO7
	ROT.TLO7T.199676
Capacity	1100 - 2300 kg
Number of columns	2
Column layout	symmetrical
Mode of drive	electrohydraulic
Control	on both sides
Energy kit	standard
Type of installation	surface-mounted
Max. lifting height	1803 mm
Lifting time	45 s
Lowering time	40 s
Cylinder height at max. stroke	3778 mm
Clear span between	2915 mm
Drive-through width	2324 mm
Switchoff level	4032 mm
Min. ceiling height	4200 mm
Wheelbases wheel alignment	762 - 2235 mm
Arm layout	asymmetrical
Driving power	3 kW
Power Supply	230/400 V 50 Hz
Phases	3 Ph
Width	3496 mm
Height	4166 mm
Weight	980 kg

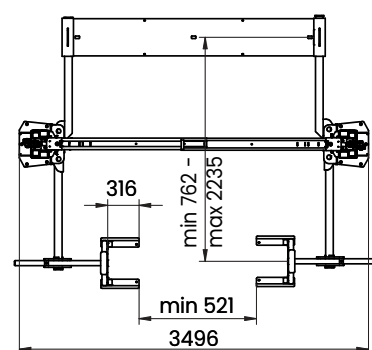
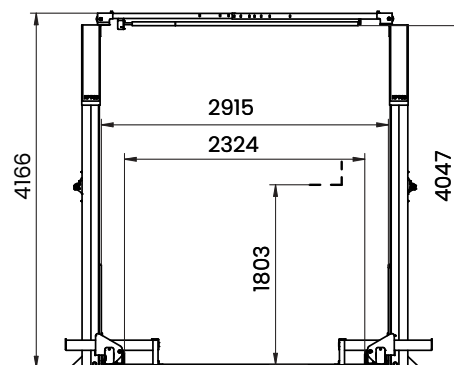

Technical changes reserved. Data are considered advertisement.



GERMANY **BlitzRotary GmbH** Hüfanger Straße 55 | 78199 Bräunlingen | +49 771 9233 0
 ITALY **Vehicle Service Group Italy S.r.l.** Via F. Brunelleschi 9 | 44020 Ostellato FE | +39 051 6781511
 FRANCE **RAV France SARL** 4, Rue De Longue Raie, ZAC de la Tremblaie | 91220 Le Plessis Pâté | +33 1 60 86 88 16
 UK **Vehicle Service Group UK Ltd** 3 Fourth Avenue, Bluebridge Industrial EST | Halstead, Essex, CO9 2SY | +44 1787 477711

a **DOVER** company

✉ info.emea@rotarysolutions.com

 ROTARYsolutions.eu